

INSTALLATION OF YOUR TEMPERATURE SENSOR ///

YOUR PACKAGE CONTAINS THE FOLLOWING ITEMS:

- 1 Temperature Sensor
- 1 External Temperature Probe
- 1 Rigid Antenna
- 1 Wall Mounting Kit
- 2 AAA Alkaline Batteries

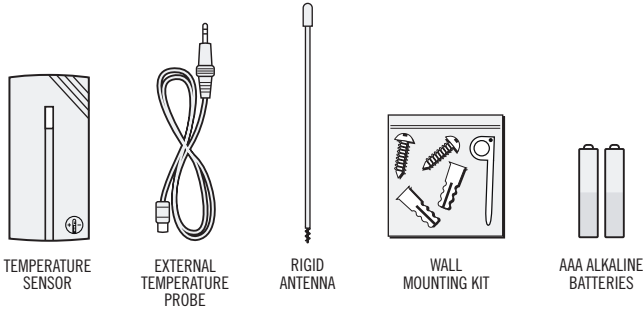

MOUNTING YOUR SENSOR:

The HMSM4150 **Temperature Sensor** is constructed of UV resistant ABS plastic allowing for indoor or sheltered outdoor use. The Sensor works by monitoring ambient temperature and senses changes ranging between 14°F to 104°F (-10°C to 40°C). If the temperature moves outside of your preferred range, it is reported to the XG1000 Controller and an event is triggered.

1. Determine the desired location where you would like to mount your Sensor. Using the mounting holes on the back of the Sensor as a guide, drill two small holes for each of the mounting screws, using a 7/32" drill bit for drywall (or other composite surfaces) or a 1/16" drill bit for other solid surfaces. Insert supplied wall anchors into holes and secure sensor to wall with supplied screws leaving 1/16" space between the screw head and the wall. Mount the Sensor onto the screws and slide down to lock into place. You may alternately affix the Sensor using the provided double-sided tape.
2. Locate the antenna and screw it into the top-right corner of the sensor, just above the air vents, until it is secure.
3. Insert the batteries. On the bottom of the sensor, slide open the door and insert two AAA alkaline batteries. The back of the door of the sensor indicates the polarity (+ and -) of the batteries. Close the door after inserting batteries.

NOTE: The sensor does not support rechargeable NiCad or NiMH batteries. However, the sensor does employ built-in power saving functionality.

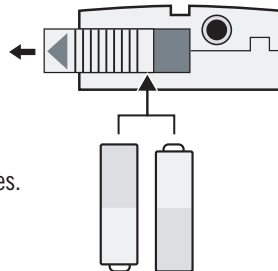

DISCOVERING YOUR SENSOR:

1. In your Remote Account, select the **Account Settings** tab and then select **Discovery**.
2. Press the **'START DISCOVERY'** button and wait until you get a message indicating discovery is in progress.
3. On the back side of the Sensor, press the **Discovery Button** using the **Discovery Tool**.

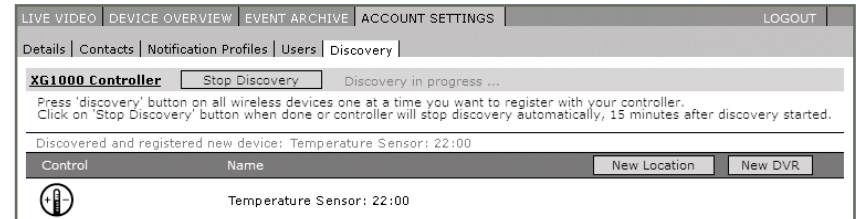
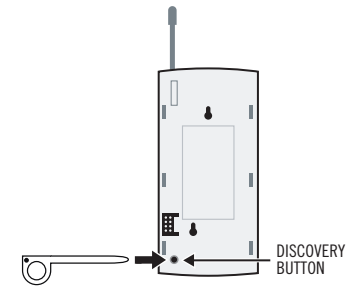

4. Press the **'STOP DISCOVERY'** button. Go to the **Device Overview** page and make sure that the Sensor appears in the list.

EXTERNAL TEMPERATURE PROBE

With the use of the **External Temperature Probe** you can extend the temperature sensitivity range of the **Temperature Sensor** to between -40°F and 140°F (-40°C and 60°C). The probe simply plugs into the base of the Sensor, is submersible and is designed to monitor the temperature of both air and water. A pool, aquarium, deep freezer, and/or baseboard radiator are just a few suggested places where you can use your External Temperature Probe to monitor both ambient and water temperature.

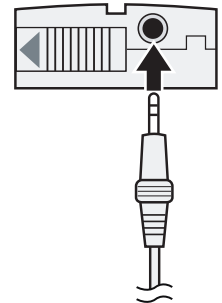

TROUBLESHOOTING ///

If you are having trouble operating this product, please consult the guide below:

PROBLEM	SOLUTION
LED does not light up	<ol style="list-style-type: none">1. Ensure the batteries are properly inserted with the correct polarity.2. Ensure you are using fully charged AAA batteries.
The XG1000 Controller does not recognize the sensor during discovery	<ol style="list-style-type: none">1. Ensure sensor is powered. Position the sensor in closer proximity to your XG1000 Controller and try again. Ensure there are no other wireless devices interfering with the sensor. The sensor transmits on the 418 MHz frequency.

PROBLEM	SOLUTION
Events are not triggered	<ol style="list-style-type: none"> 1. Ensure the batteries are properly inserted with the correct polarity. 2. Ensure you are using fully charged AAA batteries.
Sensor continually sends an event	<ol style="list-style-type: none"> 1. Ensure sensor is powered. Position the sensor in closer proximity to your XG1000 Controller and try again. Ensure there are no other wireless devices interfering with the sensor. The sensor transmits on the 418 MHz frequency.

FAQ'S ///

HOW FAR AWAY CAN THE SENSOR BE PLACED FROM THE XG1000 CONTROLLER?

Typically 60 feet.

CAN I PLACE THE SENSOR IN A DIFFERENT ROOM FROM THE XG1000 CONTROLLER?

Yes, the sensor uses radio frequencies to communicate with the XG1000 Controller. These frequencies can travel through objects such as walls, ceilings, and floors.

HOW LONG WILL THE BATTERY LAST?

The batteries are expected to last up to 12 months. This will depend on actual use and how often the Temperature Sensor is triggered.

HOW MANY SENSORS CAN I USE WITH MY SYSTEM?

The XG1000 Controller can support up to 32 sensors.

THE LED INDICATOR ON THE SENSOR IS NOT ON?

This indicates that the sensor has gone into hibernation mode to save battery power. It will wake up when the sensor is triggered.

TECHNICAL SPECIFICATIONS ///

- Device signal communication
- Attaches to any flat non-metal surface
- Operates on 2-AAA Alkaline batteries
- LED indicator when sensor is triggered

Typical Range Outdoors:	250 feet
Typical Range Indoors:	60 feet
Frequency Range:	418 MHz (US); 433 MHz (EU)
Sensor Size:	3.43"L x 1.61"W x 0.59"H (87mm x 41mm x 15mm) (not including probe)